

Fiche Technique Bordures et Caniveaux

Conforme à la norme NF EN 1340 et NF P98-340/CN

A1 (110 kg)

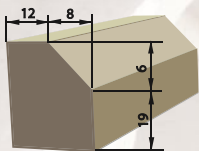

A2 (65 kg)

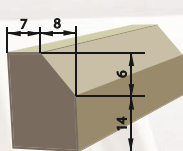

P1 (36 kg)

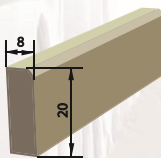

P3 (35 kg)

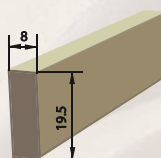

T1 (51 kg)

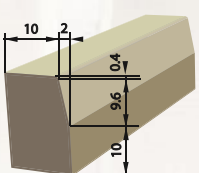

T2 (81 kg)

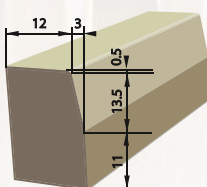

T3 (103 kg)

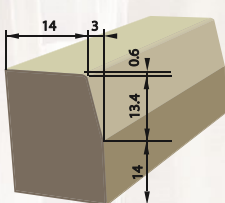

T2 basse (44 kg)

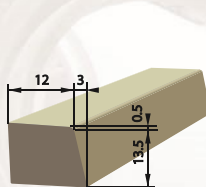

CS1 (52 kg)

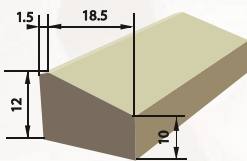

CS2 (70 kg)

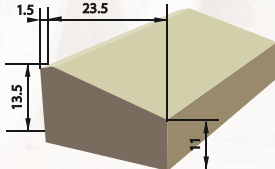

CS3 (90 kg)

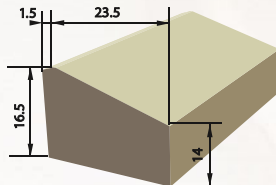

CS4 (124 kg)

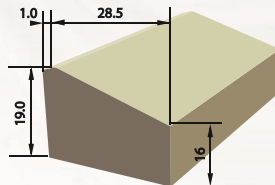

CC1 (110 kg)

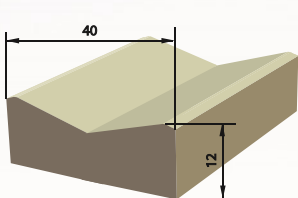

CC2 (150 kg)

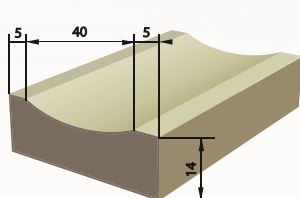

AC1 (112 kg)

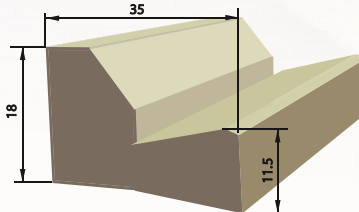

AC2 (97 kg)

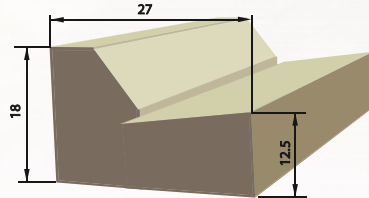

I1 (58 kg)

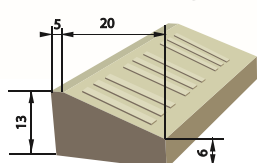

I1 lisse (58 kg)

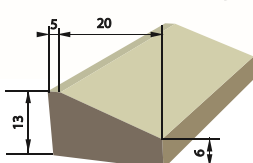

I2 (85 kg)

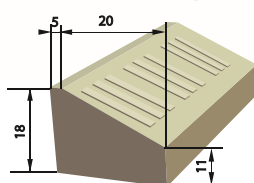

I2 lisse (85 kg)

